

RASHID BEHBUDOV

DP2 Fast Catamaran / 150 Passenger capacity

W2W system / 35 knots max speed



GENERAL DATA

Type	High Speed Craft catamaran
Year built / Place of build	2016, Henderson, Western Australia
Class	DNVGL / RMRS
Flag	Azerbaijan
Port of registry	Baku
Call sign	4JRQ
IMO number	9780720
Service speed	30 knots

DIMENSIONS

Length overall	70.0 m
Breadth	16.0 m
Molded Depth	6.00 m
Maximum Draft	2.32 m
Freeboard at Summer Draft	3.68 m
Gross Tonnage	1441 t
Net Tonnage	433 t
Deadweight	112 t
Deck Strength	2 t/m ²
Deck Area	274 m ²

CAPACITIES

Fuel Oil	60 m ³
Fresh Water	10 m ³

PROPULSION

Main Engines	4 x 2880 KW MTU-16V 4000 M73L
Bow Thruster	4 x 300 hp Thrustmaster
Waterjets	4 x 900 Hamilton

AUXILIARIES

Diesel Alternators	4 x 550 kW C 18 Caterpillar
Diesel Alternator Emergency	1 x 99 kW C 4.4 Caterpillar

SPEED

Maximum	35 knots
Normal	30 knots
Economical	15 knots

FUEL CONSUMPTION PER HOUR

FO Consumption – Full Speed	736-755 liters per hour for each engine
FO Consumption – Economical Speed	265-270 liters per hour for each engine

NAVIGATION EQUIPMENT

Radars	2 x Kelvin Hughes
Echo Sounder	2 x Furuno
Gyro Compass	3 x Meridian Standart
Auto Pilot	1 x Simrad
Doppler Log	1 x Walkers
GPS	1 x SAAB
ECDIS	2 x Kelvin Hughes
Magnetic Compass	1 x Cassens plate
AIS	1 x SAAB
Navtex	1 x NCR-333

COMMUNICATION EQUIPMENT

MF Transceiver	2 x Sailor
Satcom	T&T
GMDSS	3 x Sailor
VHF	2 x Sailor
Internet	VSAT
Inmarsat C	2 x Sailor

LIFESAVING APPLIANCES

MES	2 systems, each comprising of 2 x 100-man life rafts, vessel total is 400-person capacity
Lifejackets	175 pcs
Immersion Suits	20 pcs
FRB	1 x 15 pers

FIRE FIGHTING APPLIANCES

Fixed system	NOVEC 1230 fire suppression system
BA	2 sets
IMDG BA	2 sets

ACCOMMODATION

Cabins	9 pcs (1 x 1 man 8 x 2 man)
Crew	17 pers
Passengers	Upper deck 46 Lower Deck 99 VIP 1 x 6 Max passenger number 151, 1 spare seat is provided for passenger attendants
Hospital	1

MOORING EQUIPMENT

Anchor	1 x SHHP Pool TW fully balanced
Capstan	4 x 25 t Brevini ED1250
Anchor Winch	1 x Hypac Hyd OP20D3000CCMU

DP EQUIPMENT

DP System	Kongsberg K-Pos DP21
DP Class	DNV Class 2
DP References	2 x DGPS 1 x CYSCAN 1 x RADIUS

PASSENGER TRANSFER MEANS

FROG	FROG 10
Gangway	Walk 2 Work system A24 - type Ampelmann

The vessel is fitted with an Ampelmann A24 type W2W Gangway system allowing transfer of personnel to Offshore installations at the height of up to (approximately) 20 meters from the vessel and 20 meters above sea level (distances dependent on site specific conditions). The vessel has a FROG 10 (basket system) allowing passenger transfer when weather conditions prohibit Ampelmann utilization.

VESSEL SPECIFIC CHARACTERISTICS

Rashid Behbudov is a DP 2 Catamaran vessel with a normal service speed of 30 knots, with a range of 600 NM at 30 knots and 2300 NM at 15 knots. The vessel can transport 150 passengers together with 16 crew members in sea states of up to 3.0 meters. Wooden sheeting on the back deck provides 274 m² of deck space for transportation of deck cargo up to 2 mt/m². Ride comfort is enhanced by the utilization of a vessel motion stabilization system. Passenger seats are fitted with airline style personal audio systems, large screen TVs are in the passenger areas so safety briefings etc. can be shown on passage. The passenger area is divided into 3 lounges, 1 VIP and 2 general areas.

SPECIFICATIONS	
OVERALL LENGTH(excl APPENDAGES)	70.0m
WATERLINE LENGTH	67.6m
BEAM(excl SPRINGS)	14.0m
PASSENGERS:	150 (132 SEATS)
CREW:	18 (16 BERTHS)
CONSTRUCTION:	ALUMINIUM
FUEL OIL:	4 x 15000 L
FRESH WATER:	2 x 5000 L
GREY WATER:	5000 L
BLACK WATER:	3000 L
MACHINERY:	4 x MTU 16V4000 M73L
RATED POWER:	4 x 2800kW @ 2050rpm
PROPULSION:	4 x HT-900 S WATERJETS
BOW THRUSTERS:	4 x THROOMLR 225kW
AFT DECK AREA:	440m²

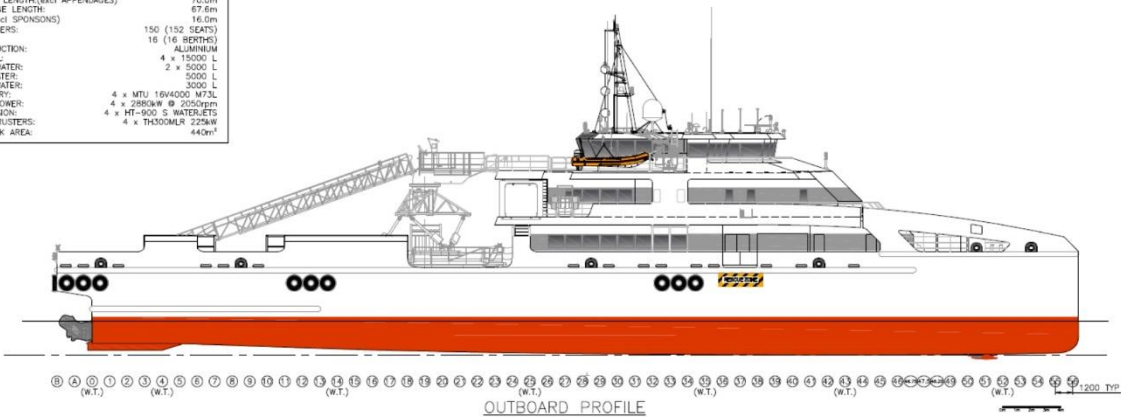

OUTBOARD PROFILE

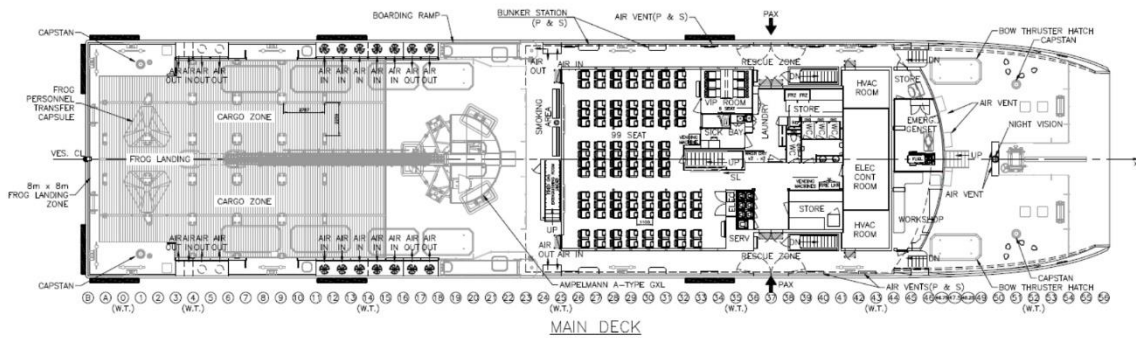
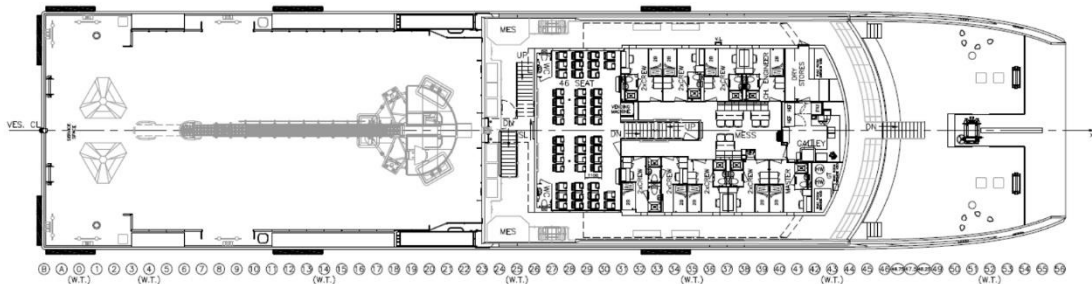
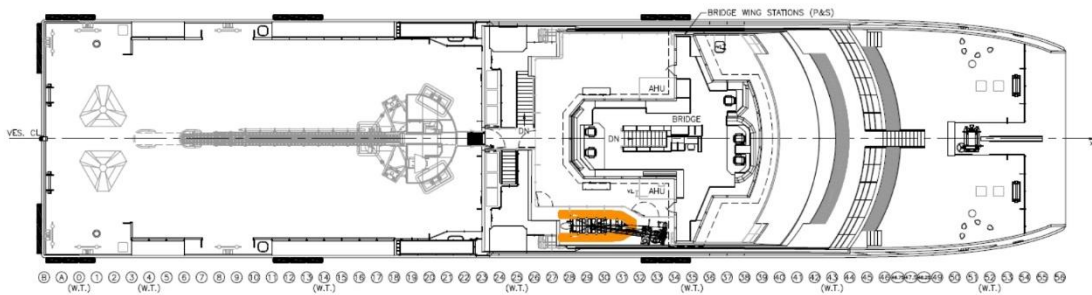

MAIN DECK



Incat Crowther
70m CATAMARAN FAST CREW BOAT

	PROJECT: 70m CATAMARAN FAST CREW BOAT	
	TITLE: 102020-001	
	GENERAL ARRANGEMENT	
ISSUE No: 392-100-001	SHEET No: 2 OF 4	DRAWING REV: X
DESIGNER:	DATE PLOTTED:	SCALE 1:6
CHECKED:	CHECKED:	CHECKED:

- - - - FAR REVISION HISTORY SEE SHEET 1			
ISSUE	SHT	ZONE	DETAILS

DATE	DRN	SRU	
------	-----	-----	--

ACA 00120-004
100 GARDENS ROAD, HOBART TAS
6000 TASMANIA, AUSTRALIA
Tel: (075) 921 1000 Fax: (075) 921 1001

This drawing has been produced by manual means and is not intended to be reproduced by any means without prior approval from AUSTAL.

A1

